

AdventHealth Hendersonville

Campus Map & Brownsberger Facility

Campus Map

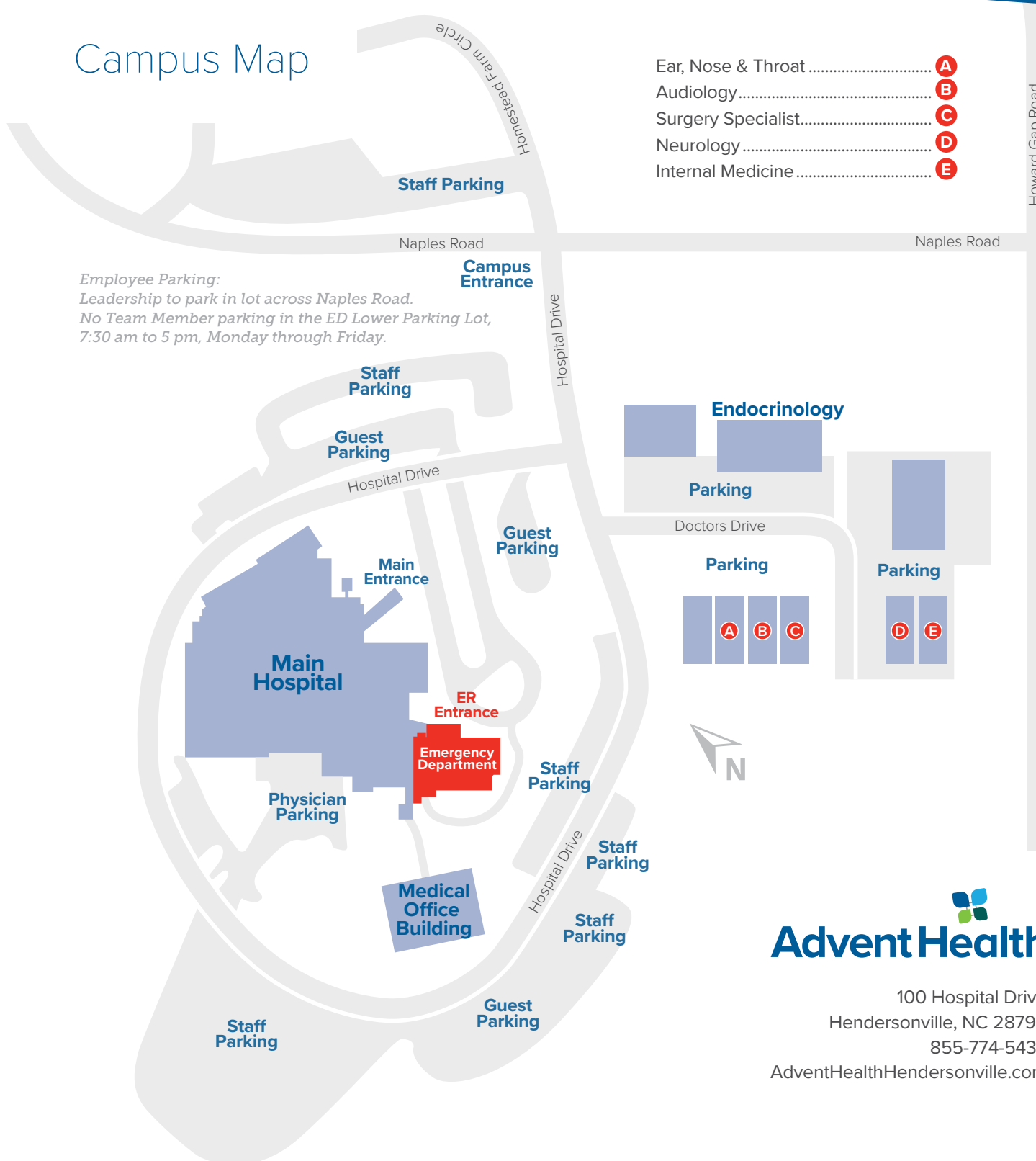

AdventHealth

100 Hospital Drive
Hendersonville, NC 28792
855-774-5433
AdventHealthHendersonville.com

AdventHealth Hendersonville Main Campus

First Floor



Ground Floor

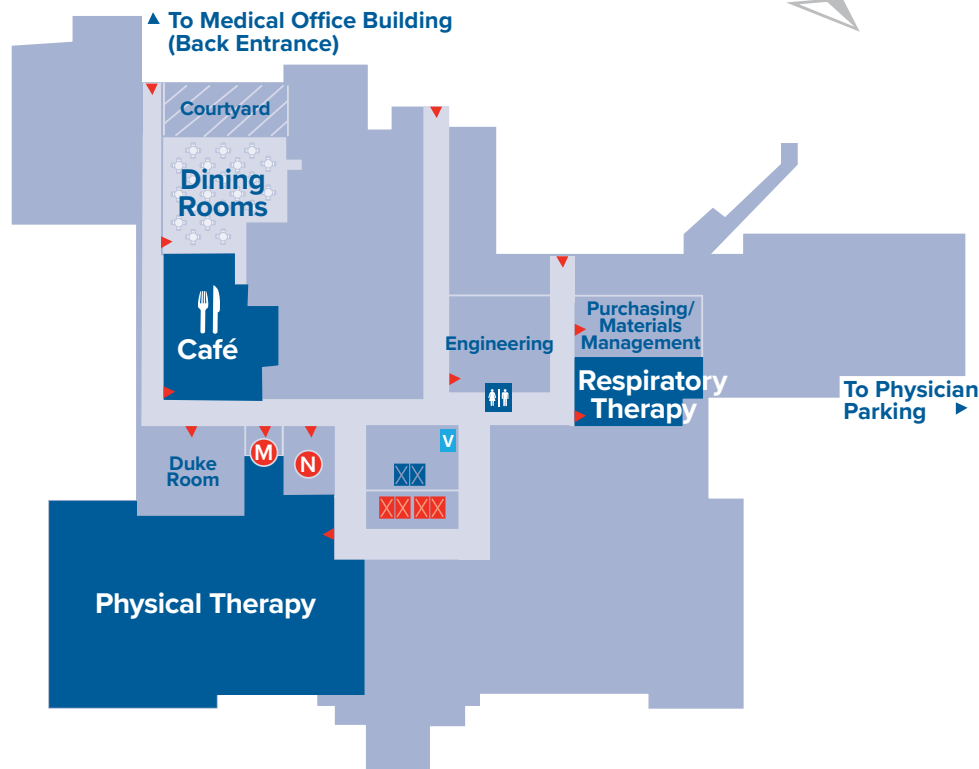

Guest Services

- FREE Coffee, Tea and Water 24 hours in Dining Rooms

Second Floor*

Geropsychiatric
Women's Psychiatric
Pharmacy
Case Management

Third Floor*

ICU
Med/Surg

**Not visible in this map illustration*

Room # _____

Elevator _____

Floor _____

Brownsberger Circle

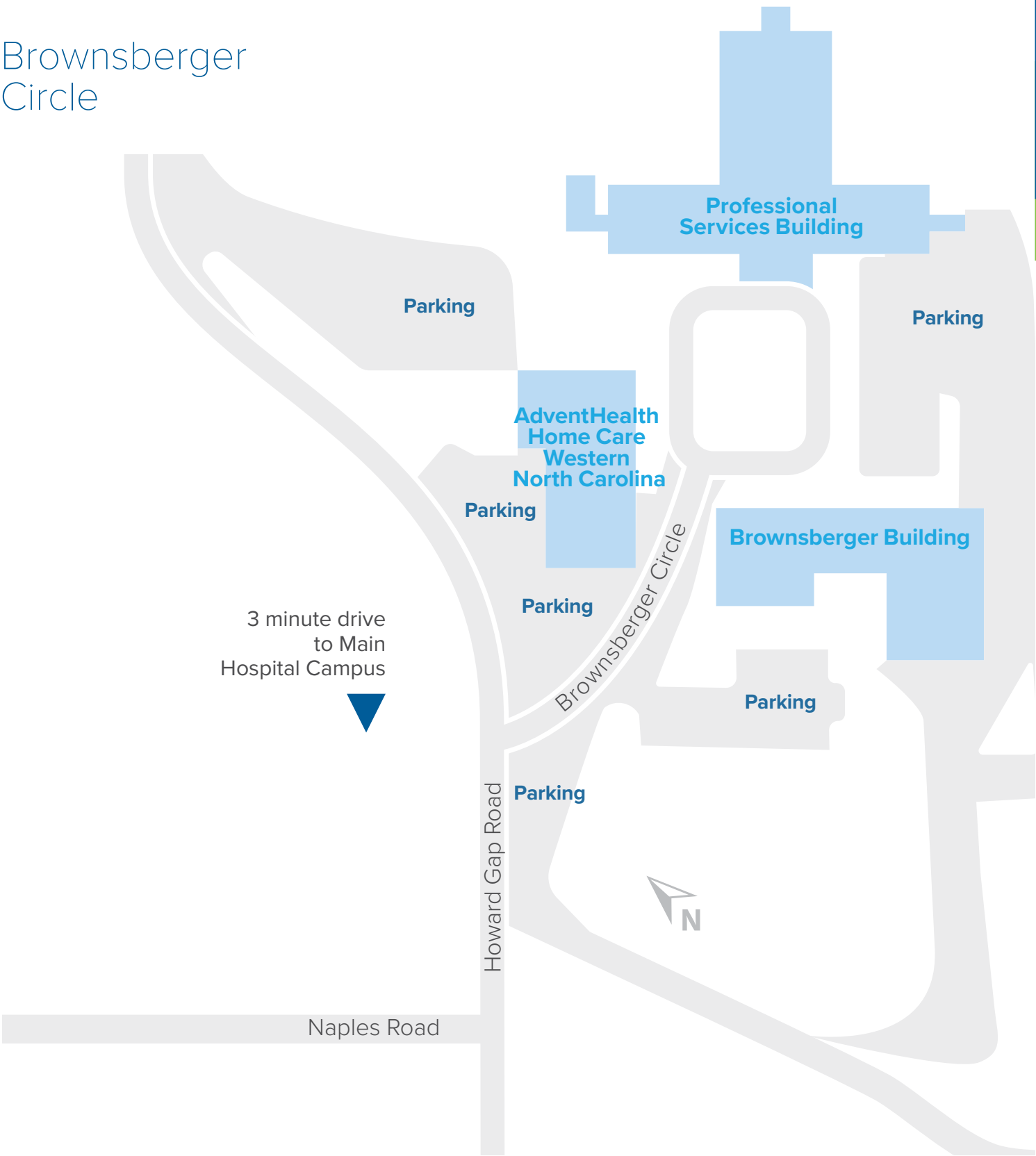

AdventHealth complies with applicable federal civil rights laws and does not discriminate on the basis of race, color, national origin, age, disability or sex.

ATENCIÓN: si habla español, tiene a su disposición servicios gratuitos de asistencia lingüística. Llame al número siguiente 407-303-3025.

ATANSYON: Si w pale Kreyòl Ayisyen, gen sèvis èd pou lang ki disponib gratis pou ou. Rele nimewo ki anba an 407-303-3025.



AdventHealth Primary Care and Specialists

WELCOMING NEW PATIENTS WITH SAME-DAY AND NEXT-DAY APPOINTMENTS AVAILABLE

1 50 Hospital Drive Hendersonville, NC 28792

AdventHealth Hematology Oncology
Infusion Services Hendersonville*

AdventHealth Medical Group Multispecialty
at Medical Office Building*

- Family Medicine
- Foot & Ankle
- Infectious Diseases
- Psychiatry
- Spine Health

AdventHealth Medical Group Cardiology
at Medical Office Building*

AdventHealth Medical Group Dermatology
at Medical Office Building*

AdventHealth Medical Group Integrative
Medicine at Medical Office Building*

AdventHealth Medical Group
Obstetrics & Gynecology
at Medical Office Building*

AdventHealth Medical Group
Pediatrics at Medical Office Building*

AdventHealth Medical Group
Psychiatry at Medical Office Building*

AdventHealth Medical Group
Pulmonary & Sleep Medicine
at Medical Office Building*

AdventHealth Medical Group
Urology at Medical Office Building*

AdventHealth Medical Group
Wound Care & Hyperbaric Medicine
at Medical Office Building*

* A hospital department of AdventHealth Hendersonville

** A service of AdventHealth Hendersonville

2 50 Doctors Drive Hendersonville, NC 28792

AdventHealth Medical Group
Internal Medicine at Hendersonville*

AdventHealth Medical Group
Neurology at Hendersonville*

80 Doctors Drive Hendersonville, NC 28792

AdventHealth Medical Group
Audiology at Hendersonville*

AdventHealth Medical Group
Breast Center at Hendersonville*

AdventHealth Medical Group
Ear, Nose & Throat at Hendersonville*

AdventHealth Medical Group
Rheumatology at Hendersonville

AdventHealth Medical Group
Surgery Specialists at Hendersonville*

81 Doctors Drive Hendersonville, NC 28792

AdventHealth Medical Group
Endocrinology at Hendersonville*

3 1881 Pisgah Drive Hendersonville, NC 28791

AdventHealth Medical Group
Multispecialty at Laurel Park*

- Family Medicine
- Internal Medicine
- Lab
- Primary Care Behavioral Health
- PT Solutions Physical Therapy

Age-Friendly Center

- Geriatrics
- Geriatric Behavioral Health
- Henderson County Council on Aging

4 One Town Square Boulevard Suite 220, Asheville, NC 28803

AdventHealth Medical Group
Family Medicine at Biltmore Park*

5 15 Skyland Inn Drive Arden, NC 28704

AdventHealth Medical Group
Multispecialty at South Asheville*

- Family Medicine
- Spine Health
- Internal Medicine
- Obstetrics & Gynecology
- Psychiatry
- Primary Care Behavioral Health
- Urogynecology

6 125 Vance Hill Drive Mills River, NC 28759

AdventHealth Medical Group
Family Medicine at Mills River*

7 127 Vance Hill Drive Mills River, NC 28759

AdventHealth Medical Group
Family Medicine at Forge Mountain*

8 207 Linda Vista Drive Hendersonville, NC 28792

AdventHealth Medical Group
Family Medicine at Hendersonville*

9 100 Hospital Drive Hendersonville, NC 28792

AdventHealth Hendersonville

- Behavioral Health
- Emergency Room
- Imaging
- Inpatient/ Outpatient Surgery
- Inpatient Lab
- Labor & Delivery

10 333 Gashes Creek Road Asheville, NC 28803

AdventHealth Medical Group
Family Medicine at Parkway*

- Primary Care Behavioral Health

333 Gashes Creek Road, Suite 111 Asheville, NC 28803

AdventHealth Medical Group
Multispecialty at Parkway*

- Sleep Medicine

11 15 Jane Jacobs Road, Suite 101 Black Mountain, NC 28711

AdventHealth Medical Group
Family Medicine at Black Mountain*

12 20 Medical Park Drive, Suite B Asheville, NC 28803

AdventHealth Cancer Services at Asheville*

13 179 North Buncombe School Road, Suite 102 Weaverville, NC 28787

AdventHealth Cancer Services at Weaverville*

14 49 Spicewood Drive, Suite 10B Clyde, NC 28721

AdventHealth Cancer Services at Haywood*
Infusion Center

600 Hospital Dr, Suite 2 Clyde, NC 28721

AdventHealth Cancer Services at Haywood*

15 Water Oaks Suites 123 East Main Street, Suite 102 Brevard, NC 28712

AdventHealth Medical Group
Family Medicine at Brevard

16 436 Airport Road Arden, NC 28704

AdventHealth Centra Care Urgent Care**

17 1388 Sand Hill Road, Suite 1 Candler, NC 28715

AdventHealth Medical Group
Multispecialty at Candler*

- Internal Medicine
- Family Medicine
- Rheumatology
- Lab
- Imaging

18 21 S. Main Street Robbinsville, NC

AdventHealth Medical Group Multispecialty
at Graham County

- Primary Care
- Imaging

